



RA12-155SH (12V155Ah) (580w/cell)

HR (High Rate) series is especially designed for heavy load discharge applications with 10 years design life in float service. By using strong grids and specially designed active material the HR series offers stable performance during high current discharge requirements. The HR series offers 30% more power output than the standard range. Suitable for UPS/EPS where high current loads are required.



Specification

Cells Per Unit	6
Voltage Per Unit	12
Capacity	580W@15min-rate to 1.67V per cell @25°C
Weight	Approx. 47.0 Kg(Tolerance ± 1.5%)
Max. Discharge Current	1550A (5 sec)
Internal Resistance	Approx. 3.9 mΩ
Operating Temperature Range	Discharge: -40°C~60°C Charge: 0°C~50°C Storage: -20°C~60°C
Normal Operating Temperature Range	25°C ± 5°C
Float charging Voltage	13.6 to 13.8 VDC/unit Average at 25°C
Recommended Maximum Charging Current	46.5 A
Equalization and Cycle Service	14.6 to 14.8 VDC/unit Average at 25°C
Self Discharge	RITAR Valve Regulated Lead Acid (VRLA) batteries can be stored for more than 6 months at 25°C. Self-discharge ratio less than 3% per month at 25°C. Please charge batteries before using.
Terminal	Faston tabF5/F12
Container Material	A.B.S. UL94-HB, UL94-V0 Optional.



MH28539



G4M20206-0910-E-16



CERTIFICATE

Postcode: 421001
is in conformity with

ISO 14001:2004 Standard



CERTIFICATE

Postcode: 421001
is in conformity with

OHSAS 18001:1999 Standard

Dimensions

Unit: mm Dimension: 344(L) × 173(W) × 285(H)

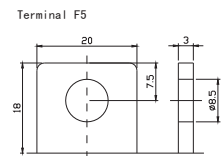
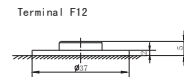
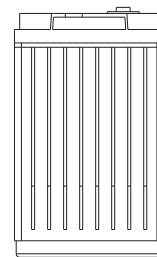
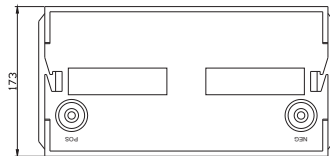
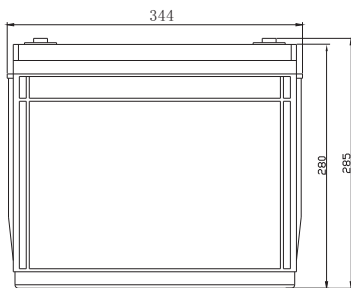

Constant Current Discharge Characteristics : A(25°C)

F.V /Time	5MIN	8MIN	10MIN	15MIN	20MIN	30MIN	60MIN	90MIN
9.60V	471.9	416.3	370.5	332.3	255.3	180.6	101.1	80.6
10.0V	440.6	394.4	349.0	319.5	240.5	173.9	99.2	77.9
10.2V	427.1	384.9	337.5	310.3	234.0	171.0	97.5	76.5
10.5V	413.0	370.5	322.2	299.5	222.8	164.7	95.2	75.0
10.8V	394.9	355.9	302.5	290.1	215.7	157.8	92.9	73.7
11.1V	369.1	327.7	284.5	274.4	208.0	152.6	90.1	70.8

Constant Power Discharge Characteristics : W(25°C)

F.V /Time	5MIN	8MIN	10MIN	15MIN	20MIN	30MIN	60MIN	90MIN
9.60V	4979	4 464	3980	3651	2819	2015	1131	902
10.0V	4693	4 286	3808	3545	2682	1959	1106	876
10.2V	4582	4 171	3708	3479	2630	1930	1098	867
10.5V	4474	4 078	3573	3375	2535	1884	1092	862
10.8V	4324	3 915	3409	3283	2457	1821	1074	855
11.1V	4165	3 708	3253	3166	2402	1767	1054	830

All mentioned values are average values (Tolerance ±2%).

RA12-155SH

12V155Ah



Effect of temperature on long term float life

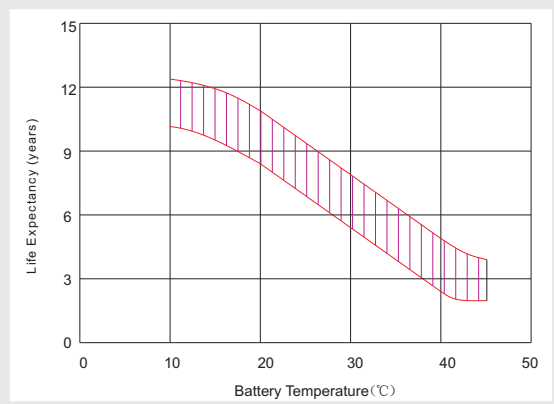

Storage characteristic

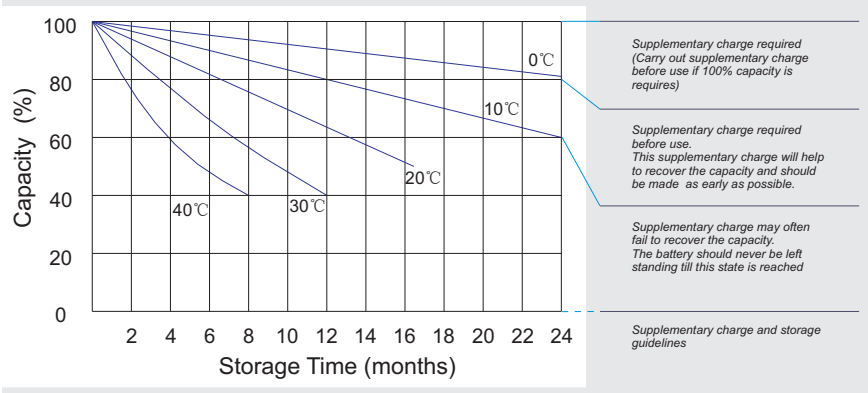

Charge characteristic Curve for standby use

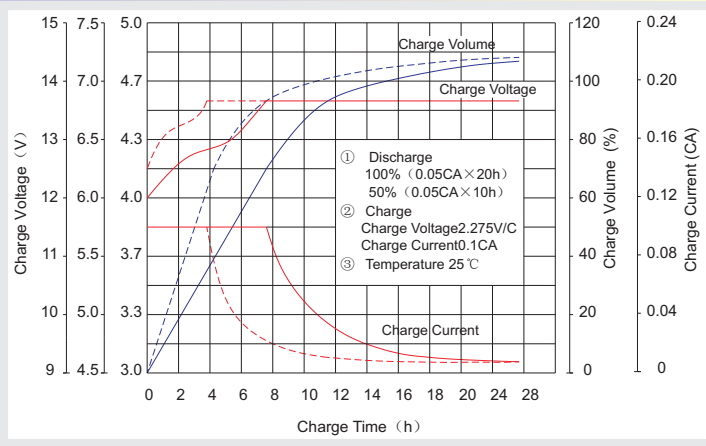

Discharge characteristic Curve

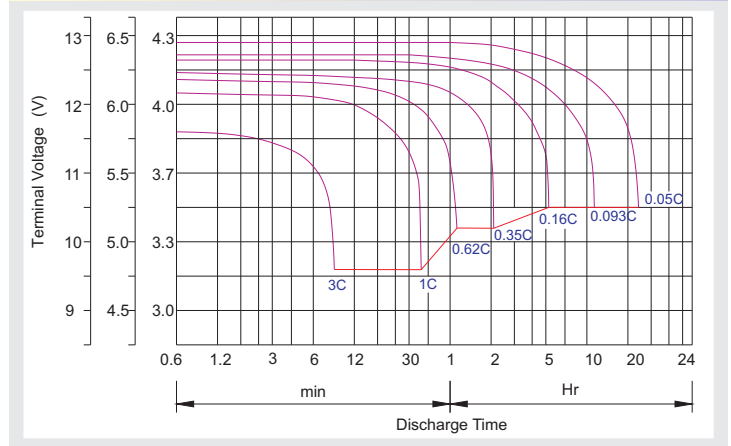

Capacity Factors With Different Temperature

Battery Type		-20°C	-10°C	0°C	5°C	10°C	20°C	25°C	30°C	40°C	45°C
GEL Battery	6V&12V	50%	70%	83%	85%	90%	98%	100%	102%	104%	105%
	2V	60%	75%	85%	88%	92%	99%	100%	103%	105%	106%
AGM Battery	6V&12V	46%	66%	76%	83%	90%	98%	100%	103%	107%	109%
	2V	55%	70%	80%	85%	92%	99%	100%	104%	108%	110%

Discharge Current VS. Discharge Voltage

Final Discharge Voltage V/cell	1.75V	1.70V	1.60V
Discharge Current (A)	(A) ≤ 0.2C	0.2C < (A) < 1.0C	(A) ≥ 1.0C

Charge the batteries at least once every six months, if they are stored at 25°C.

Charging Method:

Constant Voltage	-0.2Cx2h+2.4-2.45V/cellx24h, Max. Current 0.3C
Constant Current	-0.2Cx2h+0.1Cx12h
Fast	-0.2Cx2h+0.3Cx4h

Bolt	M5	M6	M8
Terminal	F3 F4 F13 F18 T25 T26	F8 F11 F12-1 F15	F5 F9 F10 F12 F14 F16
Torque	6~7N·m	8~10N·m	10~12N·m

Maintenance & Cautions

Float Service:

- ※ Every month, recommend inspection every battery voltage.
- ※ Every three months, recommend equalization charge for one time.

Equalization charge method:

Discharge: 100% rate capacity discharge.

Charge: Max. current 0.3CA, constant voltage 2.4-2.45V/Cell charge 24h.

- ※ Effect of temperature on float charge voltage: -3mV/°C/Cell.

- ※ Length of service life will be directly affected by the number of discharge cycles, depth of discharge, ambient temperature and charging voltage.